

## Sink Diamant

Kitchen Sinks

Code: 3312 062



### DETAILS

Edge/Installation Type	Flat Edge
Material	AISI 304 stainless steel
Texture	Foster brushed
Base	60 cm
Dimensions	988x508 mm
Standard fittings	Fixing hooks, gasket, drain, overflow and siphon, boxed packing
Mixer holes	2 standard holes
Built-in hole	View technical data sheet
Drainer	Yes

Width	99 cm
-------	-------

Bowl dimension	340x400 + 150x300mm
----------------	---------------------

Number of bowls	2 bowls
-----------------	---------

Waste fitting	Drain with automatic PR control
---------------	---------------------------------

## FEATURES

Added value	Foster uses steel thicknesses higher than those used on average by other manufacturers. This is how, thanks to our long experience, we know how to make sinks of superior quality and with a better resistance to aging.
-------------	--

Automatic waste fitting	The waste-fitting with round remote knob is supplied; a practical accessory which makes it unnecessary to get wet in order to drain the water from the bowl.
-------------------------	--

Basket 3,5" waste fitting	The drain is equipped with a large 3.5" drain, with the practical basket cap that prevents the discharge of solid parts.
---------------------------	--

Double mixer hole	The large tap counter is already fitted with a series of 2 tap holes. In the second hole it is possible to install the remote control of the automatic drain or, alternatively, a practical soap dispenser.
-------------------	---

## TECHNICAL DATA

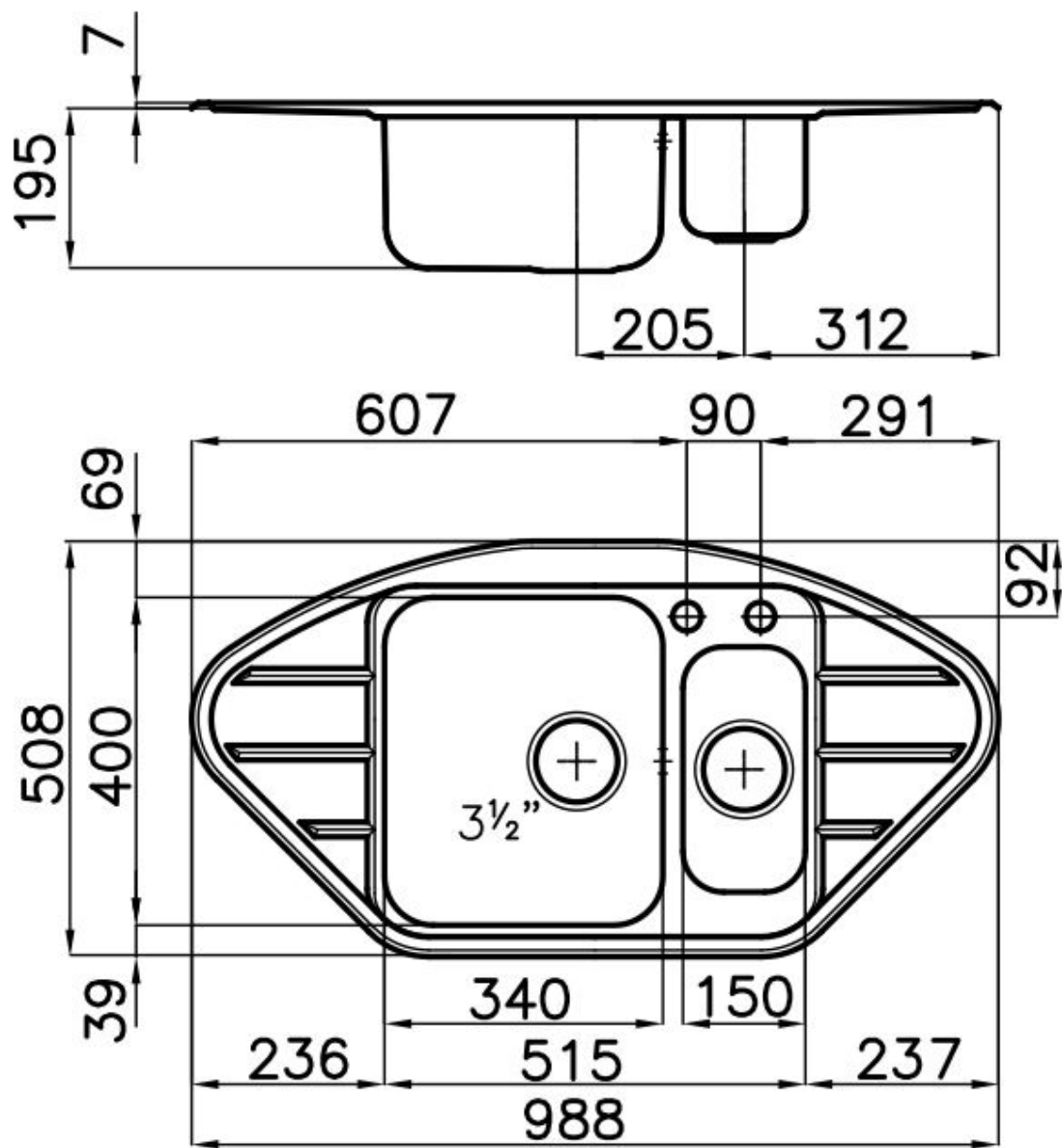

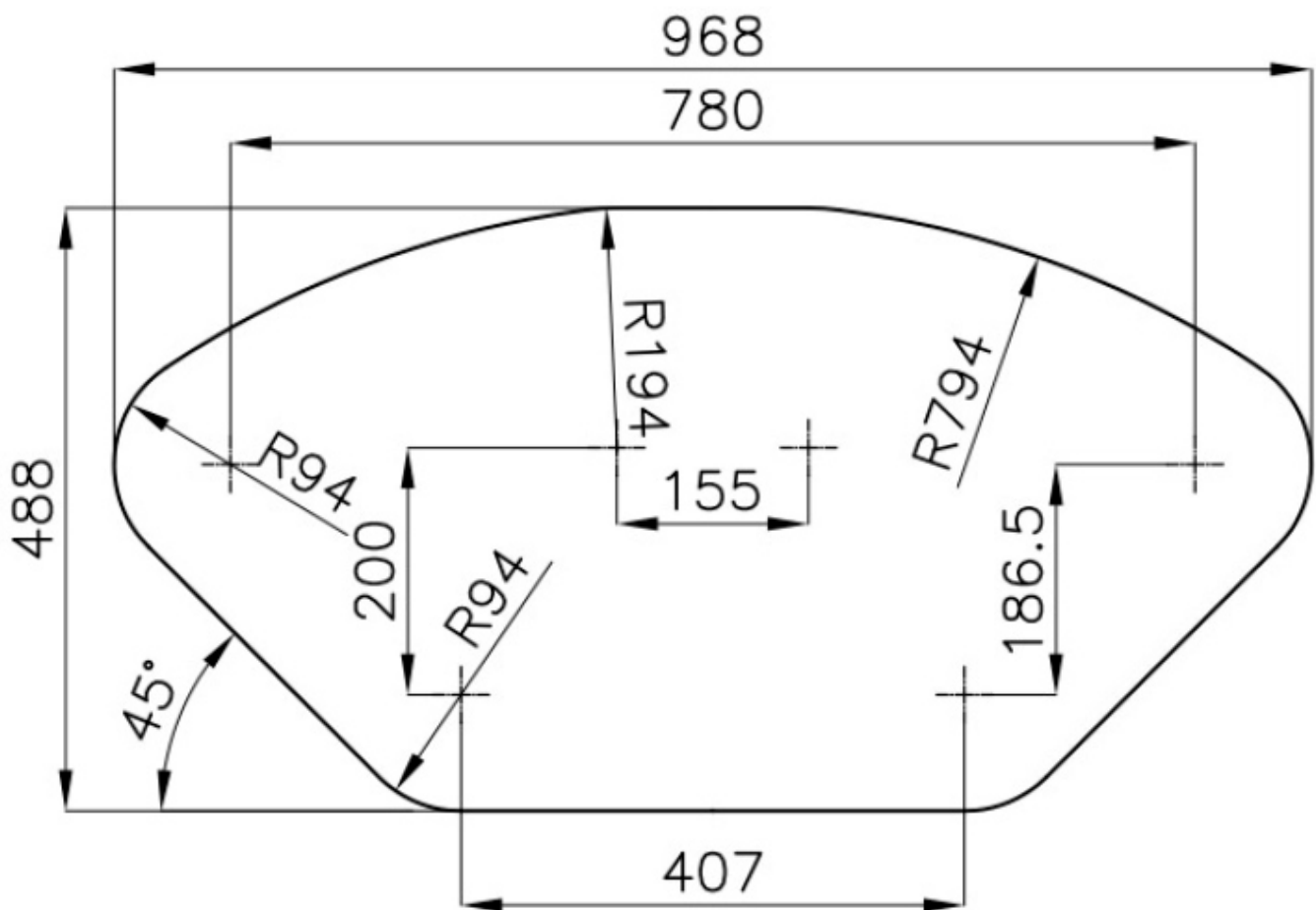

## GALLERY



## OPTIONAL ACCESSORIES



**Glass chopping board**  
8631 300



**HDPE Chopping board**  
8657 001



**Stainless steel basket**  
8611 000



**White bowl**  
8153 100



**White colander**  
8151 100